



<http://redlotusletter.com>
Pushing the envelope of feng shui

Directions fo Using the Lo Shu Square

The Bagua

The bagua is an eight-sided octagon that relates to the “Eight Aspirations.” The Eight Aspirations are the eight things the Chinese believe correspond to a happy life. These include good family relationships, children, health, good education, wisdom, assistance from helpful people, etc.

The eight aspirations also correspond with a person (mother, father, daughter, son), an element (fire, water, metal, etc.), a number, and a direction (north, south, northwest, etc.), among others. When these are all grouped together in an octagon, this is called a bagua. The bagua is essentially a roadmap of how to harmonize your home with the directions, elements, etc.

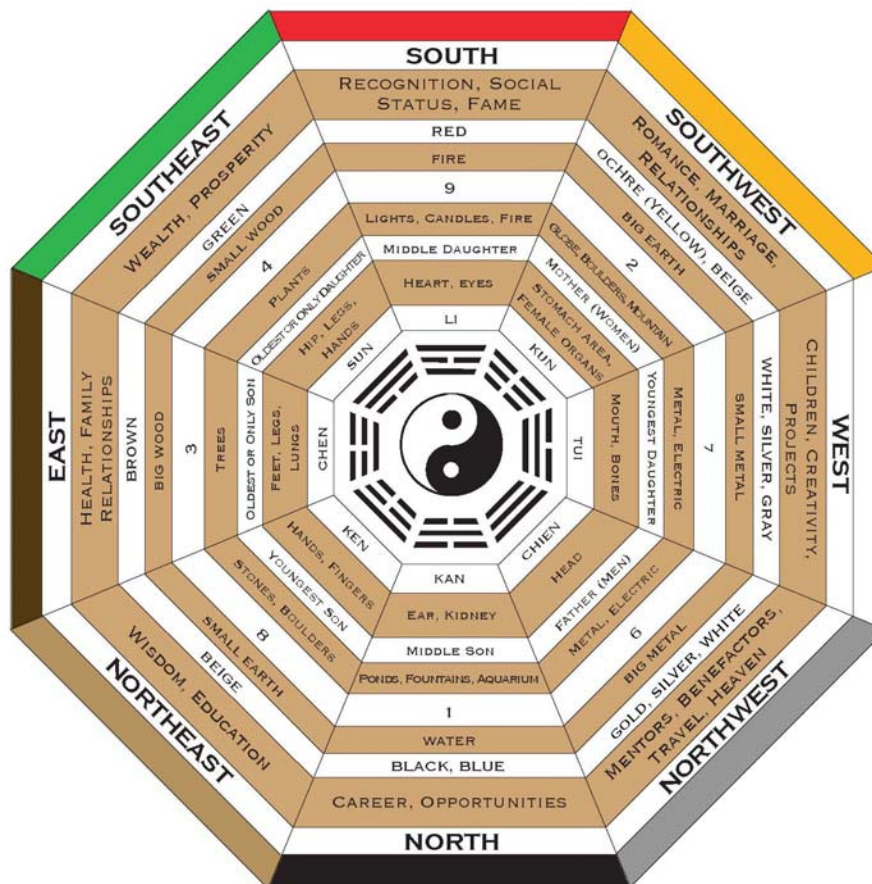

By applying the bagua to the footprint of your home, you can determine if there are elements at odds with a particular sector. Or, you can also tell if you are missing a sector. If you are, then chances are the aspiration that corresponds to that particular sector is impacted. So, for instance, if you are missing the south sector, it is possible that you have few friends or you have troubles with your good name.

The example below illustrates how to apply a lo shu square over your house or space. The lo shu square is essentially the feng shui bagua, but in a square shape. This is generally considered the easiest way to assess the individual areas of your house or whatever space you choose to apply the Lo Shu Square to. The house below is a good example of a house that has some positives and negatives going for it, and it shows how to overlay the lo shu square correctly onto your house plan.

Directions for applying the lo shu square to your house or office layout:

Using graph paper, measure and mark off the outline, or "footprint," of your house. Try using 1 square for each 2 feet of space. Or, on plain paper, use .5 inches for every three feet. Next, you will want to divide the space into nine equal squares. Divide these equally by measuring the width and dividing by three. This will be the width for each square. Draw your width lines here. Next, measure the length, and again, divide by three and make a mark at each measurement. Draw your length lines here.

Next, using a compass, determine the direction of your front door.

- Measure this by taking a direction reading standing in the center of the doorway, looking out, and with the door open. Stand just inside the threshold. Hold the compass level and be sure not to have jewelry, belts, or other metallic objects on you while taking the reading. This is the reading you will use to determine the direction your house faces (provided your house and door are parallel).

Now, mark the box with the direction of your front door, wherever that box is. In the example below, you'll see that the front door faces South. That means that the next box, going in a clockwise direction, is then SW. Continue labeling the boxes in this manner. Next, try to be certain that the boxes, and the corresponding house corners, do actually correspond to the actual directions that they are labeled as.

In the example house on the next page, you will notice the following in the diagram below:

- **The SE or Wealth corner is missing from the home.** This family will have difficulties with finances. To correct this, the owner should hang a large mirror on the SE wall of the dining area. This will help "exand" the area and make it appear to be there. It will also "double" the food area – which is especially good feng shui.

This family should consider closing in the missing section with a garden space, which is also excellent for the SE corner. They could also place a beautiful fountain here. A fountain in this location would be especially auspicious, and since it is to the left of the door (looking out), there is no danger that the husband will wander toward other women as can happen when a fountain is to the right of the door (looking out the door).

Lastly, the family should consider placing a screen in the doorway or a curtain to block the view of the dining area from the front door. This can lead to a loss of money. Couple that with the SE sector missing, and you've got a family that really is losing money. Since the

dining area is in the East sector of family relationships, it would be nice to place everyone at the table according to their personal auspicious (pa kua) directions.

- **The SW is taken up by a garage.** This is not the best location for the garage, nor is it the worst. The SW is the romance, marriage, and mother/woman sector of the house. At least it's not missing, right? This area should be kept tidy and made attractive with clay pots of flowers at the outside entrance. A rock garden or large boulders (painted gold, too!) between the front door and the garage would be excellent!
- **The stairs "empty" out the front door.** This is not good because it causes energy, opportunities and recognition to drain away. The front door is a very important part of every home. A crystal or windchime in this location will help to dispel the energy. A crystal can also be placed here, and if there is a light in the foyer, this should also be kept turned on here.
- **The living room is in the NW corner of the home and is excellent.** This is the place of the patriarch of the family. Having a large TV or stereo in this location is also excellent. To make this living even more auspicious, I would suggest moving the two sofas and placing a large chair for the man of the house directly in the NW corner.

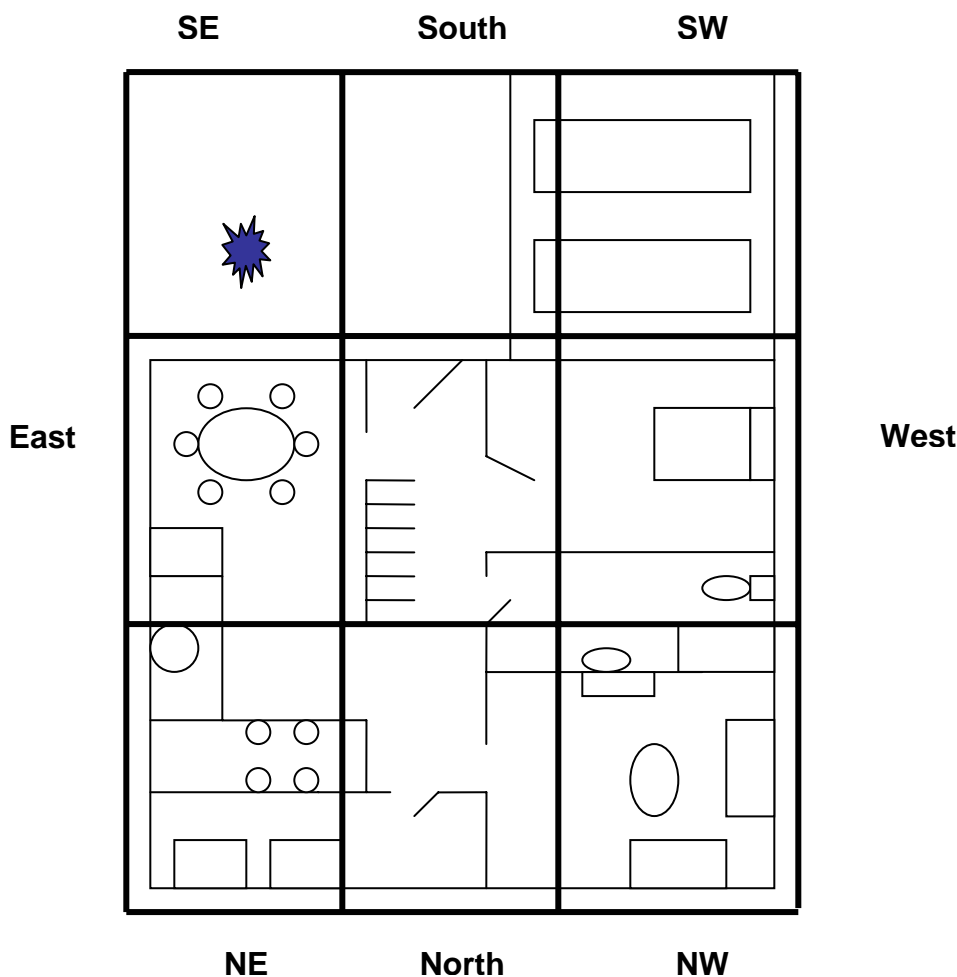

The Red Lotus Letter Lo Shu Square

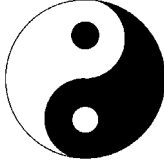
<p>Southeast Wealth, abundance, prosperity,</p> <table border="1"> <tr><td>Element:</td><td>Small wood</td></tr> <tr><td>Shape:</td><td>rectangle</td></tr> <tr><td>Color:</td><td>Green (purple, blue, black)</td></tr> <tr><td>Person:</td><td>Eldest daughter</td></tr> <tr><td>Objects:</td><td>Small plants, flowers, fish, waterfalls or fountains</td></tr> <tr><td>Number:</td><td>4</td></tr> <tr><td>Enhanced by:</td><td>Wooden objects, small plants</td></tr> <tr><td>Exhausted by:</td><td>Metal, white objects or white flowers</td></tr> </table>	Element:	Small wood	Shape:	rectangle	Color:	Green (purple, blue, black)	Person:	Eldest daughter	Objects:	Small plants, flowers, fish, waterfalls or fountains	Number:	4	Enhanced by:	Wooden objects, small plants	Exhausted by:	Metal, white objects or white flowers	<p>South Fame, recognition, dreams, social status</p> <table border="1"> <tr><td>Element:</td><td>Fire</td></tr> <tr><td>Shape:</td><td>Pyramids, triangles, pointed objects, arrows</td></tr> <tr><td>Color:</td><td>Red (yellow, orange, purple)</td></tr> <tr><td>Person:</td><td>Middle daughter</td></tr> <tr><td>Objects:</td><td>Barbecue pits, fireplace, lamps, candles, , trees, wood objects, flowers</td></tr> <tr><td>Number:</td><td>9</td></tr> <tr><td>Enhanced by:</td><td>Wood, red colors, fire</td></tr> <tr><td>Exhausted by:</td><td>Earth, rocks, stones, clay, water, metal</td></tr> </table>	Element:	Fire	Shape:	Pyramids, triangles, pointed objects, arrows	Color:	Red (yellow, orange, purple)	Person:	Middle daughter	Objects:	Barbecue pits, fireplace, lamps, candles, , trees, wood objects, flowers	Number:	9	Enhanced by:	Wood, red colors, fire	Exhausted by:	Earth, rocks, stones, clay, water, metal	<p>Southwest Romance, marriage, relationships</p> <table border="1"> <tr><td>Element:</td><td>Big earth, mountains</td></tr> <tr><td>Shape:</td><td>Square</td></tr> <tr><td>Color:</td><td>Beige (yellow, purple, red)</td></tr> <tr><td>Person:</td><td>Mother, matriarch</td></tr> <tr><td>Objects:</td><td>Stones, pairs, vases, crystals, globes, urns</td></tr> <tr><td>Number:</td><td>2</td></tr> <tr><td>Enhanced by:</td><td>Lamps, fire, candles, round stones or objects, clay pots and ceramic vases</td></tr> <tr><td>Exhausted by:</td><td>Wood, metal objects</td></tr> </table>	Element:	Big earth, mountains	Shape:	Square	Color:	Beige (yellow, purple, red)	Person:	Mother, matriarch	Objects:	Stones, pairs, vases, crystals, globes, urns	Number:	2	Enhanced by:	Lamps, fire, candles, round stones or objects, clay pots and ceramic vases	Exhausted by:	Wood, metal objects
Element:	Small wood																																																	
Shape:	rectangle																																																	
Color:	Green (purple, blue, black)																																																	
Person:	Eldest daughter																																																	
Objects:	Small plants, flowers, fish, waterfalls or fountains																																																	
Number:	4																																																	
Enhanced by:	Wooden objects, small plants																																																	
Exhausted by:	Metal, white objects or white flowers																																																	
Element:	Fire																																																	
Shape:	Pyramids, triangles, pointed objects, arrows																																																	
Color:	Red (yellow, orange, purple)																																																	
Person:	Middle daughter																																																	
Objects:	Barbecue pits, fireplace, lamps, candles, , trees, wood objects, flowers																																																	
Number:	9																																																	
Enhanced by:	Wood, red colors, fire																																																	
Exhausted by:	Earth, rocks, stones, clay, water, metal																																																	
Element:	Big earth, mountains																																																	
Shape:	Square																																																	
Color:	Beige (yellow, purple, red)																																																	
Person:	Mother, matriarch																																																	
Objects:	Stones, pairs, vases, crystals, globes, urns																																																	
Number:	2																																																	
Enhanced by:	Lamps, fire, candles, round stones or objects, clay pots and ceramic vases																																																	
Exhausted by:	Wood, metal objects																																																	
<p>East Health, family relationships</p> <table border="1"> <tr><td>Element:</td><td>Big wood</td></tr> <tr><td>Shape:</td><td>Rectangle</td></tr> <tr><td>Color:</td><td>Brown or green</td></tr> <tr><td>Person:</td><td>Oldest son</td></tr> <tr><td>Objects:</td><td>Plants, large wood furniture, medicines, exercise or play equipment, herbs, fruits, trees, bamboo</td></tr> <tr><td>Number:</td><td>3</td></tr> <tr><td>Enhanced by:</td><td>Water, water symbols (fish)</td></tr> <tr><td>Exhausted by:</td><td>Metal, metal objects, or fire</td></tr> </table>	Element:	Big wood	Shape:	Rectangle	Color:	Brown or green	Person:	Oldest son	Objects:	Plants, large wood furniture, medicines, exercise or play equipment, herbs, fruits, trees, bamboo	Number:	3	Enhanced by:	Water, water symbols (fish)	Exhausted by:	Metal, metal objects, or fire	<p>Center Tai Chi Color: Golden, like the sun Element: Earth</p> 	<p>West Children, creativity, projects</p> <table border="1"> <tr><td>Element:</td><td>Small metal</td></tr> <tr><td>Shape:</td><td>Round, cylinder, tube, column, arches</td></tr> <tr><td>Color:</td><td>White, silver</td></tr> <tr><td>Person:</td><td>Youngest daughter</td></tr> <tr><td>Objects:</td><td>Windchimes, small metal objects, mobiles, metal garden items</td></tr> <tr><td>Number:</td><td>7</td></tr> <tr><td>Enhanced by:</td><td>Pottery, ceramic vases, metal objects or electronic items, stones</td></tr> <tr><td>Exhausted by:</td><td>Water, fire</td></tr> </table>	Element:	Small metal	Shape:	Round, cylinder, tube, column, arches	Color:	White, silver	Person:	Youngest daughter	Objects:	Windchimes, small metal objects, mobiles, metal garden items	Number:	7	Enhanced by:	Pottery, ceramic vases, metal objects or electronic items, stones	Exhausted by:	Water, fire																
Element:	Big wood																																																	
Shape:	Rectangle																																																	
Color:	Brown or green																																																	
Person:	Oldest son																																																	
Objects:	Plants, large wood furniture, medicines, exercise or play equipment, herbs, fruits, trees, bamboo																																																	
Number:	3																																																	
Enhanced by:	Water, water symbols (fish)																																																	
Exhausted by:	Metal, metal objects, or fire																																																	
Element:	Small metal																																																	
Shape:	Round, cylinder, tube, column, arches																																																	
Color:	White, silver																																																	
Person:	Youngest daughter																																																	
Objects:	Windchimes, small metal objects, mobiles, metal garden items																																																	
Number:	7																																																	
Enhanced by:	Pottery, ceramic vases, metal objects or electronic items, stones																																																	
Exhausted by:	Water, fire																																																	
<p>Northeast Education, wisdom, spirituality</p> <table border="1"> <tr><td>Element:</td><td>Small earth</td></tr> <tr><td>Shape:</td><td>Flat, low mounds</td></tr> <tr><td>Color:</td><td>Beige, yellow, red</td></tr> <tr><td>Person:</td><td>Youngest son</td></tr> <tr><td>Objects:</td><td>Stones, cement or stone benches, rocks, bricks, anything made from earth, small hills or bumps, vases</td></tr> <tr><td>Number:</td><td>8</td></tr> <tr><td>Enhanced by:</td><td>Stones, boulders</td></tr> <tr><td>Exhausted by:</td><td>Trees, plants</td></tr> </table>	Element:	Small earth	Shape:	Flat, low mounds	Color:	Beige, yellow, red	Person:	Youngest son	Objects:	Stones, cement or stone benches, rocks, bricks, anything made from earth, small hills or bumps, vases	Number:	8	Enhanced by:	Stones, boulders	Exhausted by:	Trees, plants	<p>North Opportunities, Career, Prospects, Music, Art</p> <table border="1"> <tr><td>Element:</td><td>Water</td></tr> <tr><td>Shape:</td><td>Waves, curls, curves</td></tr> <tr><td>Color:</td><td>Black</td></tr> <tr><td>Person:</td><td>Middle son</td></tr> <tr><td>Objects:</td><td>Ponds, fish, aquarium, turtles, frogs</td></tr> <tr><td>Number:</td><td>1</td></tr> <tr><td>Enhanced by:</td><td>Metals, gold</td></tr> <tr><td>Exhausted by:</td><td>Earth, stone, clay, wood</td></tr> </table>	Element:	Water	Shape:	Waves, curls, curves	Color:	Black	Person:	Middle son	Objects:	Ponds, fish, aquarium, turtles, frogs	Number:	1	Enhanced by:	Metals, gold	Exhausted by:	Earth, stone, clay, wood	<p>Northwest Helpful people, mentors, supporters, trade, international travel</p> <table border="1"> <tr><td>Element:</td><td>Big Metal</td></tr> <tr><td>Shape:</td><td>Circular, circles, arches</td></tr> <tr><td>Color:</td><td>White, silver, or gold</td></tr> <tr><td>Person:</td><td>Father, patriarch</td></tr> <tr><td>Objects:</td><td>Metallic objects, windchimes, bells, stereos, computers, statues of religious figures</td></tr> <tr><td>Number:</td><td>6</td></tr> <tr><td>Enhanced by:</td><td>Bowls, metals</td></tr> <tr><td>Exhausted by:</td><td>Fire, pyramids, red colors, bright lights</td></tr> </table>	Element:	Big Metal	Shape:	Circular, circles, arches	Color:	White, silver, or gold	Person:	Father, patriarch	Objects:	Metallic objects, windchimes, bells, stereos, computers, statues of religious figures	Number:	6	Enhanced by:	Bowls, metals	Exhausted by:	Fire, pyramids, red colors, bright lights
Element:	Small earth																																																	
Shape:	Flat, low mounds																																																	
Color:	Beige, yellow, red																																																	
Person:	Youngest son																																																	
Objects:	Stones, cement or stone benches, rocks, bricks, anything made from earth, small hills or bumps, vases																																																	
Number:	8																																																	
Enhanced by:	Stones, boulders																																																	
Exhausted by:	Trees, plants																																																	
Element:	Water																																																	
Shape:	Waves, curls, curves																																																	
Color:	Black																																																	
Person:	Middle son																																																	
Objects:	Ponds, fish, aquarium, turtles, frogs																																																	
Number:	1																																																	
Enhanced by:	Metals, gold																																																	
Exhausted by:	Earth, stone, clay, wood																																																	
Element:	Big Metal																																																	
Shape:	Circular, circles, arches																																																	
Color:	White, silver, or gold																																																	
Person:	Father, patriarch																																																	
Objects:	Metallic objects, windchimes, bells, stereos, computers, statues of religious figures																																																	
Number:	6																																																	
Enhanced by:	Bowls, metals																																																	
Exhausted by:	Fire, pyramids, red colors, bright lights																																																	

For information on annual feng shui energy, please go to <http://www.redlotusconsulting.com/2006.html>

**WANT MORE INFORMATION ABOUT
APPLYING FENG SHUI TO YOUR HOME?**

Check out my book *Applied Feng Shui*.

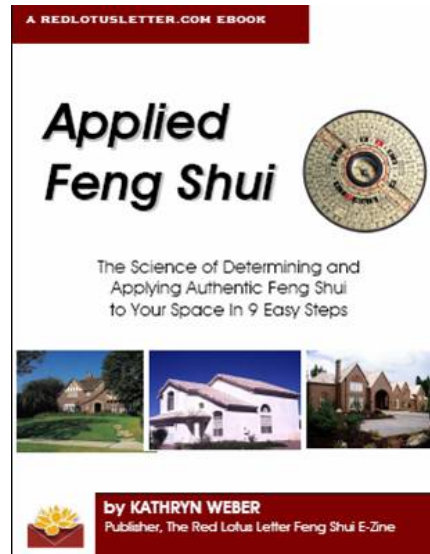

From a name you know

I've spent years coming to your email box twice a month to share feng shui information that you don't see everywhere else. The Red Lotus Letter is a unique voice in the feng shui world...one you can trust and rely on. You won't be disappointed with this feng shui book.

Why? Because this book **will answer the questions, close the loop, and fill in every blank you've had about the feng shui of YOUR home -- not anyone else's.** That's because this book is **designed to help you to discover your space and how to work with it.** Plus, Applied Feng Shui is perfect WITH other books. Start with Applied Feng Shui to truly understand your space and then use another feng shui book to apply enhancements.

For more information on ordering, click here:

http://www.redlotusconsulting.com/Ebook_Appliedfengshui12080688.html